

LOADING THE APPLICATOR

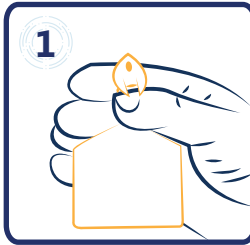

1 Hold the tag between thumb and forefinger supporting the taghead.

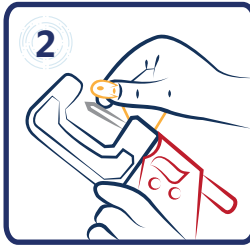

2 Introduce the head of the tag to the applicator needle.

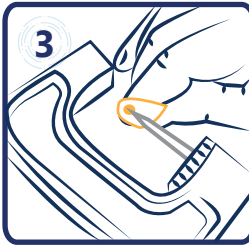

3 In a "rolling motion" utilise the "hole" in the tag head to position the feedlot tag onto the "barb" of the applicator needle, pulling it towards you, until "firmly seated".

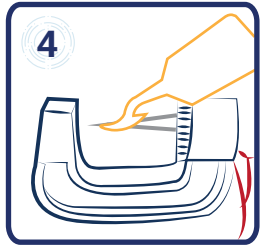

4 Ensure that the tag is positioned correctly in the applicator by checking that the "intended lettering" faces upwards. This is also the side for "number stamping".

APPLYING THE TAG

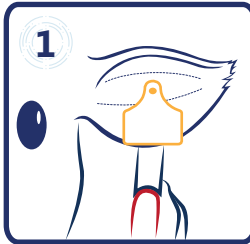

1 The Allflex feedlot applicator is designed to apply tags from the front of the animal only.

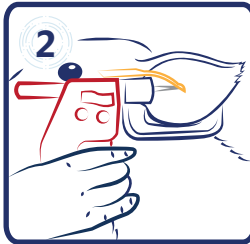

2 Position the applicator needle so that the tag is applied between the two cartilages of the ear.

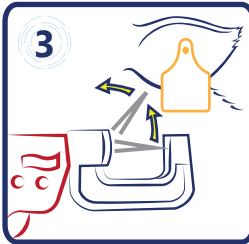

3 Effective tag application will be accomplished by applying the tag quickly. It is important that both applicator handles remain together (closed)/ trigger remains squeezed so that the needle may pivot "outwards" when the applicator is quickly withdrawn to complete the tagging operation. N.B. Failure to keep the handles together - or trigger squeezed (for Pneumatic) - may result in needle or ear damage.

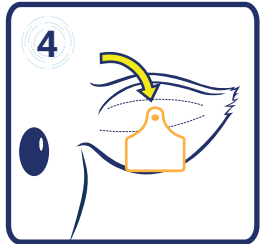

4 Optimum tag placement is centred through the ear halfway between ear tip and head. Ensure the tag is correctly "seated" in the ear after application.

